

# PRECAUTIONARY MEASURES FOR **CONSTRUCTION WORKERS**

---

**SELCO Foundation | LabourNet**

Research by Masonsink Studio

Visuals by Shrunga Srirama

*Inputs by: Mr. Ashish Bhuvan and Mr. Harikrishna B.S. from Building Resource Hub and Mr. V.S.Sree Ram, Chartered Engineer and Valuer*

# INTRODUCTION

---

In January 2020 the World Health Organization (WHO) declared the **outbreak of a new coronavirus disease** in Hubei Province, China to be a Public Health Emergency of International Concern. WHO stated there is a high risk of the 2019 coronavirus disease (COVID-19) spreading to other countries around the world.

With many restrictions being lifted around the construction industry building infrastructure for healthcare and across MGNREGA for daily wagers, precautionary measures need to be set across the following to prevent spread of contamination

1. Construction sites
  1. Large scale
  2. Micro scale
  3. Small scale
2. Labour Accommodation (on-site) and (off-site) Colonies

The health and safety concerns of the workers and other individuals who are working on these construction sites must be seen as high priority. For this purpose, this concise document on some standard operating procedures for the control of the spread of COVID-19 has been compiled.

## OVERALL CONSIDERATIONS FOR WORK SITES

---

1. General Hygiene
2. Awareness / Support to Workers
3. Entrance and Exit to Construction sites and labour colonies
4. Site maps and segregation
5. Risk of infection to various stakeholders
6. Tools and gear
7. Material and storage
8. Construction work and physical distancing/ other precautions
9. Precautions for Accommodation On site and Off sites

The partnership of LabourNet and SELCO Foundation is developing training modules for large real estate developers like LnT (for site and safety engineers, supervisors and labour contractors) and Micro Contractors (entrepreneur) with the Building and Construction Workers' Welfare Board

This program in long term would also question safety, health and environment standards that most labour colonies have in place for the comfort of their workers.

# GENERAL HYGIENE

- Cover coughs and sneezes with an elbow or a tissue and dispose off tissues properly into assigned dustbins lined with plastic bags
- Wash hands every 2 hours with soap and water for at least 20 seconds, including before and after eating and after going to the toilet
- Use alcohol-based hand sanitisers only if water and soap are unavailable
- Washing body, hair (including facial hair) and clothes thoroughly every day before and after work
- Stay more than 2m away from others, and
- Stay home if sick.
- Avoid touching face – eyes, nose and mouth
- Avoid handshakes or any other close physical contact
- Wash your clothes as soon as you get home.

Every 1hr  20sec



HAND WASH



WEARING MASK



COUGH/SNEEZE ETIQUETTE



NO PHYSICAL CONTACT



DO NOT TOUCH EYES, NOSE,  
MOUTH



NO TOBACCO

*\*POSTERS EVERYWHERE WITH THESE PROTOCOLS*

# AWARENESS

---

## Support your workers

- Provide all workers information about the [risks](#) of exposure to COVID-19. Where required, workers should be trained in infection control.
- Direct all workers (whether they are at the workplace or not) to report to you if:
  - they are experiencing any symptoms
  - they have been, or have potentially been, exposed to a person who has been diagnosed with COVID-19 or is suspected to have COVID-19 (even if the person who is suspected to have COVID-19 has not yet been tested),  
or
  - they have undertaken, or are planning to undertake, any travel.
- Encourage workers to report if they observe another worker is displaying any symptoms.
- Prohibit workers working if they are displaying symptoms.
- Prohibit workers who have contracted COVID-19 from returning to the workplace until they provide evidence they are clear of the virus.

# ENTRANCE TO SITE/ LABOUR COLONY

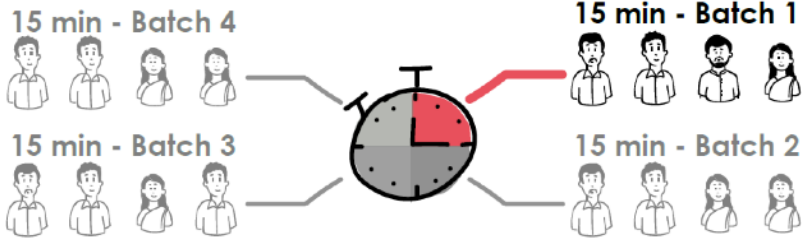

## BATCH ENTRY

Multiple points of hand wash facilities with automatic soap dispenser to be provided across the construction site to promote hand wash hygiene every hour. Sprinkler taps to be provided to conserve water.

WITH A FOOT PEDAL  
MULTIPLE STATIONS ACROSS  
THE SITE/SETTLEMENT

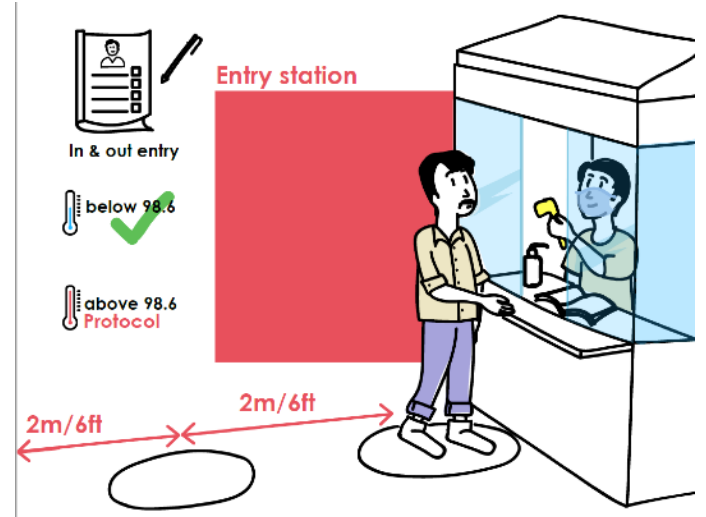

SINGLE COMMON ENTRY -EXIT POINTS  
THERMAL SCREENING/ symptoms by "Designated supervisor" at entrance  
HAND AND GENERAL HYGIENE

# WORK SITE LAYOUT AND SEGREGATION

DESIGNATED AREAS | . PHYSICAL DISTANCING | . DISTRIBUTION OF HAND WASH AREAS

- Nominate a responsible supervisor or safety supervisor on site to make sure your workers are following all the procedures listed in the guidelines.
- Place [signage](#) about the various procedures around the work site where you can.
- Frequently touched surfaces on a construction site, including any plant, equipment, lifts, hoists, handrails and doors, should be cleaned frequently using appropriate detergent or disinfectant solutions.
- Site amenities, including lunch rooms, site offices, change rooms, toilets, showers, drink fountains and vending machines, should be cleaned at high frequency every two hours at max.
- Washroom facilities on construction sites should have adequate supplies for good hygiene, such as adequate supply of soap and water. Washroom facilities must be kept clean, properly stocked and in good working order.
- \*Plan for what to do if staff arrive sick at work and communicate this to the workers - e.g. who do they need to contact, identify an isolation room or separated area.
- All area around to be fumigated and disinfected atleast once a week.
- Briefing of workforce periodically

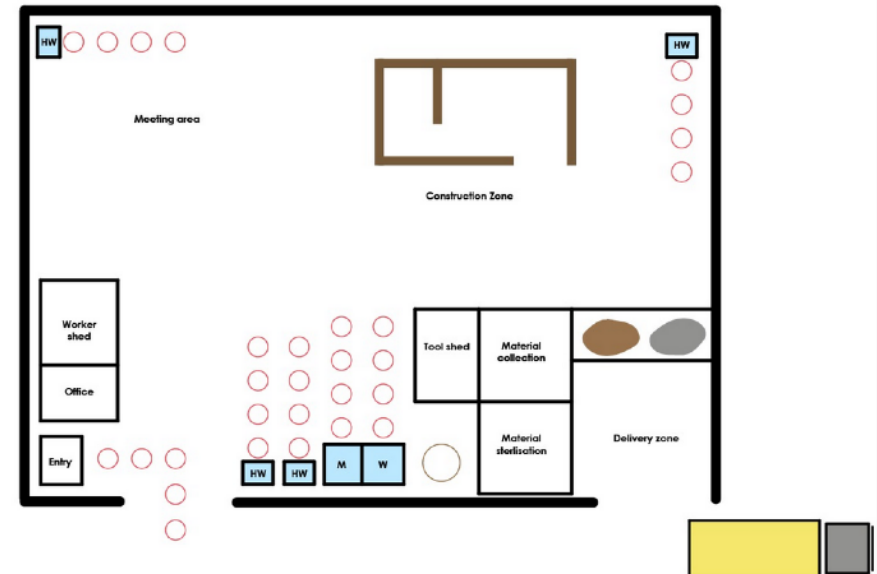

\* In addition, if construction is taking place within an occupied building, steps must be taken to minimize contact with areas within the building but not within the construction site and to clean and sanitize those areas regularly.

## RISK OF INFECTION

---

\*For people who spend full day on site only. Limit any unnecessary visitors to the site, e.g sales staff, office staff, family members or clients. For others who visit for a few hours, masks, gloves and a protective layer that can be sanitized after every use is to be considered  
Important role of home owners and clients on ensuring protocols on sites and in accommodation



Client  
Govt. Rep



Architect  
Project lead



Vendor  
Material delivery



Carpenter  
Fabricator



Mason  
Laborer



Helper



Low

Medium

High



## TOOLS USAGE AND MANAGEMENT

---



- Segregated spaces for each worker to hang clothes
- Properly labeled protective gear – masks, gloves, hard hats etc. for each worker
- Properly labeled tools for each worker
- Preferably tools to not be shared between workers
- Clean and disinfect surfaces and tools before and after use
- Usage of gloves washed every shift

## MATERIAL DELIVERY AND STORAGE

---

- Deliveries and other contractors who need to attend the workplace should be given clear instructions of your requirements while they are on site.
- **Minimize the number of workers attending to deliveries** – limit it to 2 persons + 1 supervisor. Make alcohol-based hand sanitizer or ensure hands are washed with soap and water after physically handling deliveries.
- Direct visiting truck drivers to **remain in vehicles** and use contactless methods such as mobile phones to communicate with your workers wherever possible.
- Use, and ask deliveries and contractors to use, **electronic paper work** and **online transfer of cash** where possible, to minimize physical interaction. Where possible, set up alternatives to requiring signatures. For instance, see whether a confirmation email or a photo of the loaded or unloaded goods can be accepted as proof of delivery or collection (as applicable).

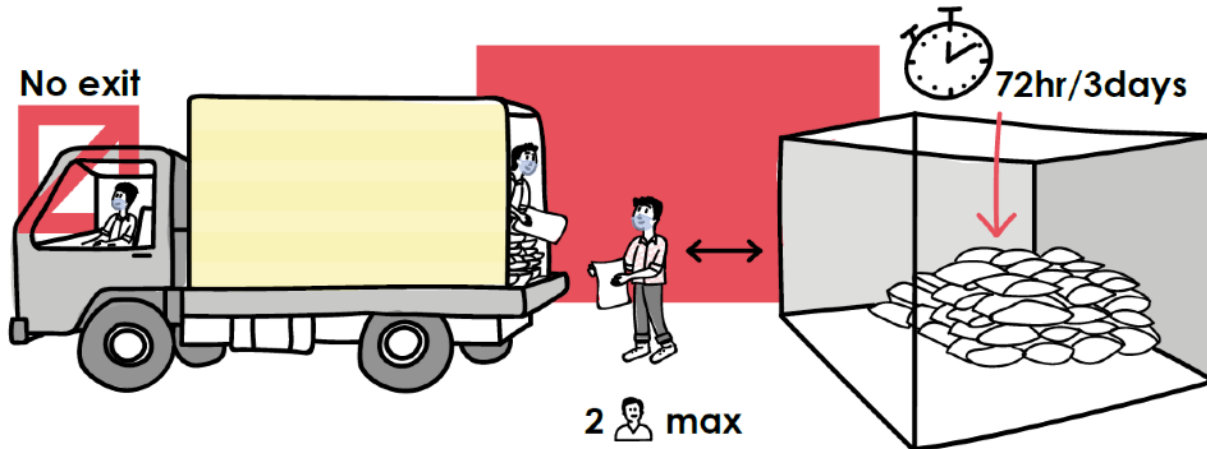

# CONSTRUCTION PHYSICAL DISTANCING

- Adopt a coordinated approach to reducing the number of workers utilising the common areas at a given time (minimising the numbers of workers in workgroups or teams e.g. only send the necessary numbers of workers to complete a task.).
- Staggering shifts of different jobs/tasks as much as possible
- Staggering starting times on site for groups of 4-5 every 15-20 minutes to prevent crowding when entering site
- Hold meetings in an outside or large space to enable physical distancing
- Site planning to facilitate appropriate physical distancing (two metres) between workers during any particular shift
- When setting up fixed workspaces on site, ensure they are away from other people, high traffic areas and amenities
- Reduce the number of tasks to be completed each day
- Create specific walkways through the construction site to maintain physical separation.
- Break times – Tea/Coffee/Lunch
- Physical distancing maintained
- Proper disposal of waste
- Hand washed before and after

## Physical distancing

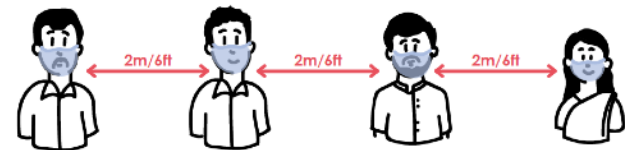
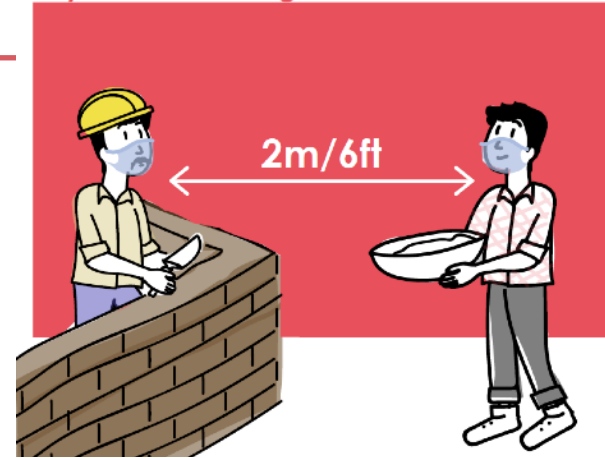

## References

Source 1: <https://www.safeworkaustralia.gov.au/covid-19-information-workplaces/preparing-workplaces-covid-19/building-and-construction-minimising>

Source 2: <https://www.ontario.ca/page/construction-site-health-and-safety-during-covid-19>

Source 3: <https://emergency.unhcr.org/entry/45582/camp-planning-standards-planned-settlements>

### Checklists for Safety Supervisor

- A. Entry/Exit Checks
  - Check the temperature
  - Ensure washing of hands
  - Ensure Change of attire
  - Ensure correct tool sanitization
- B. Work site checks
  - Ensure minimum 2m Physical distance is maintained at all time
  - Ensure materials are placed on the ground and not passed hand to hand
- C. Material Delivery Checks
  - Driver remains in vehicle
  - If cash is being handled sanitize after
  - Only 2 laborers to be at unloading dock
  - Ensure spraying of incoming supplies with sanitiser
- D. Break hour Checks
  - Check the temperature
  - Ensure washing of hands
  - Ensure proper disposal of waste
  - Ensure proper cleaning of vessels
  - Ensure proper disposal of cigarettes/beedis